

Jet



GEAR-MOTOR FOR SWING GATES



WARNINGS

Before installing the product ascertain that safety conditions are observed according to the law, rules and regulation.

Use personal safety devices and locate warning signs on the motorized gate.

Unfulfilment of the below listed direction will release the Antonioli Mario & C. sas, holder of the KING gates mark, from any responsibility for damage caused to people or things.

-Ascertain the integrity of the packing when opening it.

-In case of anomalies in the functioning, turn immediately off the gear-motor, disconnect electrical power and operate the gate manually the problem has been found and solved.

-Do not modify the product in any part.

-Only authorized and qualified staff is allowed to disassemble the product.

-Prevent any part of the automation from being next to any source of heat or in contact with liquid substances.

-Use only adequate power supply cables.

-To optimize the functioning of the automation, King gates accessories only.

-Disposal of waste material has to observe local regulations.

-Installing, testing and first functioning have to observe the laws in force.

-The gear-motor doesn't require any maintenance because provided with a permanent lubrication system.

ATTENTION: Only authorized and qualified staff can install the product according to the law in force.

PRELIMINARY CONTROL

Before installing the product, read carefully the instructions which provide guidelines about safety, installment, use and maintenance.

-Ascertain the solidity and appropriateness of the gate's frame.

-Ascertain the compatibility of the gate with the

-Ascertain the good balance of the gate.

-Ascertain the presence and good working condition of stopping devices.

-Ascertain that the gear-motor and the accessories are fixed on stable surfaces, protected from flooding and being hit.

-Ensure an easy and safe access to the manual release system.

-Remember to earth the power line.

-Ascertain the absence of power in pre-existent gates and remove any manual lock.

-Before the first functioning ascertain that the automation has been carried out according to the law in force.

TYPICAL SYSTEM

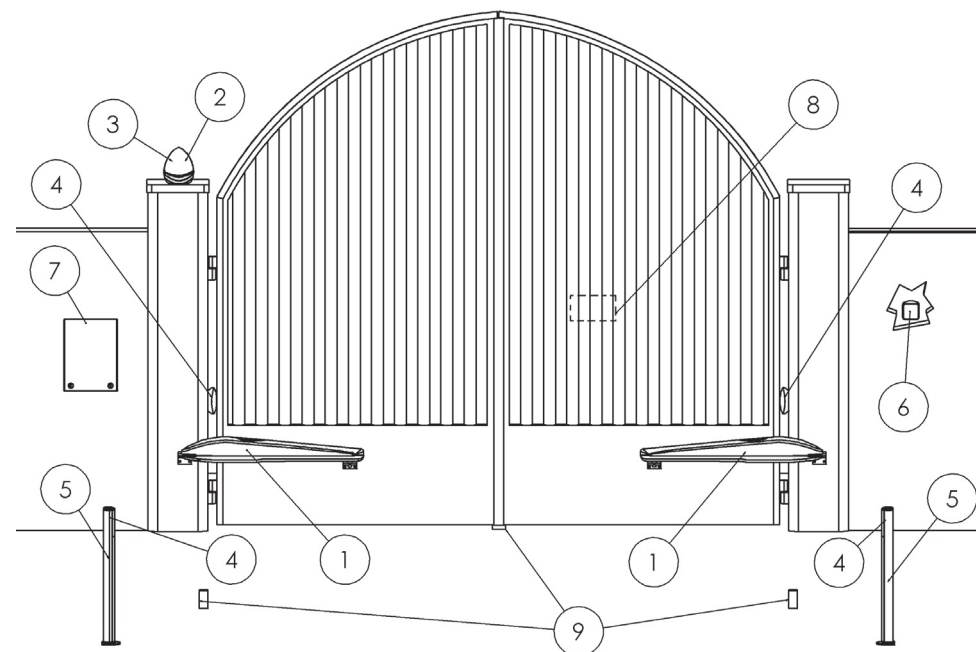

1-Gear-motor
2-Flash-light
3-Antenna
4-Photocell
5-Small column

6-Key selector
7-Control unit
8-Warning sign
9-Stop locks

OVERALL DIMANSIONS

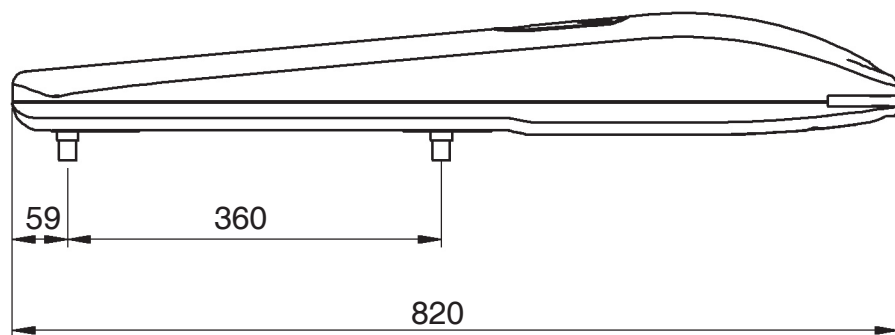
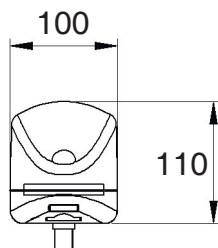

AVAIABLE VERSIONS

Code	Description
Jet 230 F	Irreversible 230 Vac, fast with opening mechanical stop
Jet 230 S	Irreversible 230 Vac, slow with opening mechanical stop
Jet 24	Irreversible 24 Vdc with opening mechanical stop

230 Vac

24 Vdc

JET 230 F

JET 230 S

JET 24

		230	230	230
Power supply	(Vac 50Hz)	230	230	230
Motor power supply	(Vac/Vdc)	230	230	24
Motor rating	(W)	200	170	50
Electrical input	(A)	1,1	1,4	3
Condenser	(µF)	8	8	-
Working temperature	(°C)	-20 ÷ +55	-20 ÷ +55	-20 ÷ +55
Termic protection	(°C)	110	110	-
IP/Rating	(IP)	IP 44	IP 44	IP 44
Max thrust	(N)	2000	2000	2000
Speed	(m/min)	0.016	0.010	0.013 ÷ 0.020
Effective strokes	(mm)	360	360	360
Frequency of use	(%)	30	30	90
Dimensions	(mm)	100x820x110	100x820x110	100x820x110
Operator weight	(Kg)	8	8	7
Max wing dimension	(m)	3	3	3

DOOR OPENING'S GRAPH

To facilitate and optimize the installation, here below are presented the graphs which enable to fix the stirrups correctly, according to the door opening angle. Infact, there's a relation between this and the stirrups position.

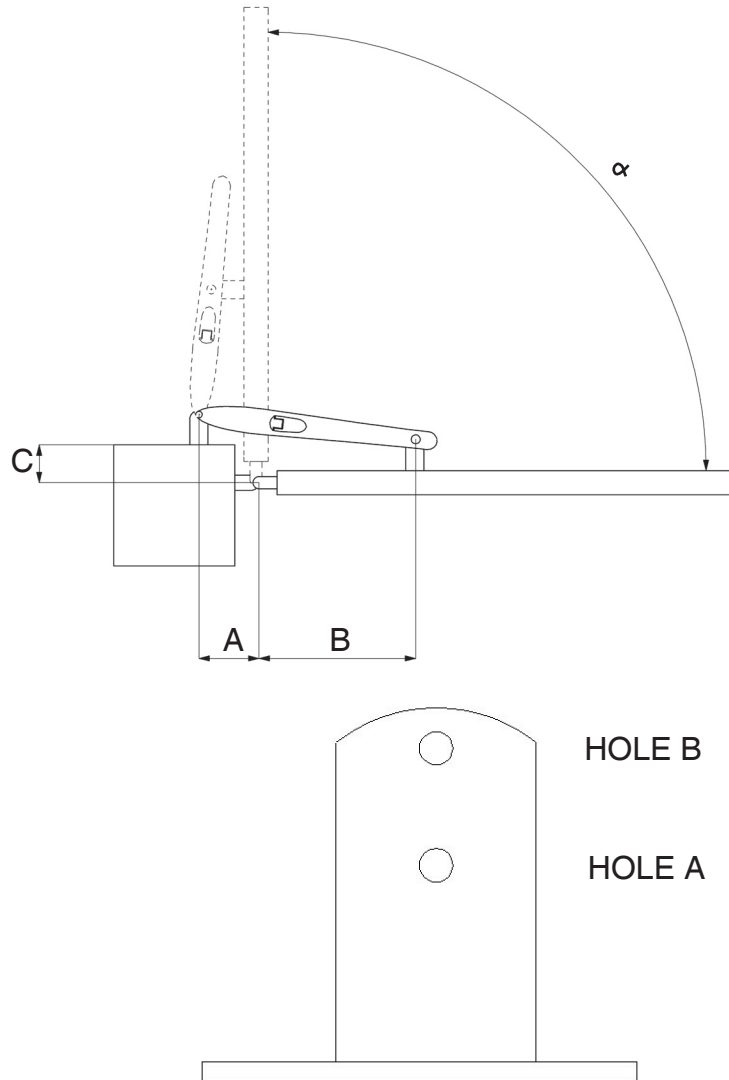

HOW TO USE A GRAPH

Measure "C" and draw a horizontal line in graph at the read measure. Choose the variance on the y axis when the motor gear is fixed on "A", on the y' axis when the motor gear is fixed on "B". The presence of two holes on the stirrup aims at optimizing the use of the motor.

Choose a position (W) on the draw line, considering the expected opening angle (" α ") adequate to the column.

Draw vertical line from (W) and determinate "A".

To continue the installation ascertain that the "A" variance allows the back stirrup to be fixed, otherwise choose another position on the graph.

Locate the just chosen position on graph 2 and determinate "B" using the curves which cross the graph vertically.

EXAMPLES OF GRAPH USE

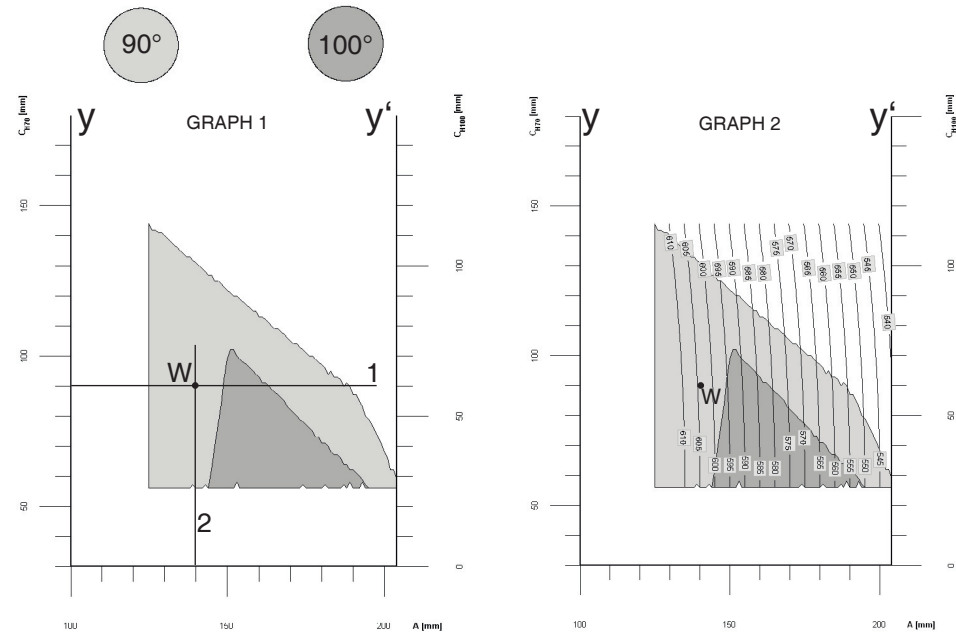

In the example we considered "C" to measure 90 mm. Once the horizontal line "1" had been drawn, we decided a 90° opening of the door. Among the "A" variances which allow such an opening angle, the most suitable to the expected conditions (in particular the column structure) was identified in the vertical line "2".

Finally, the point (W) given by the intersection of the two lines was locate in the graph 2. It can be observed that it is between the curves "605" and "600".

B can therefore approximate 603/604 mm.

GRAPH

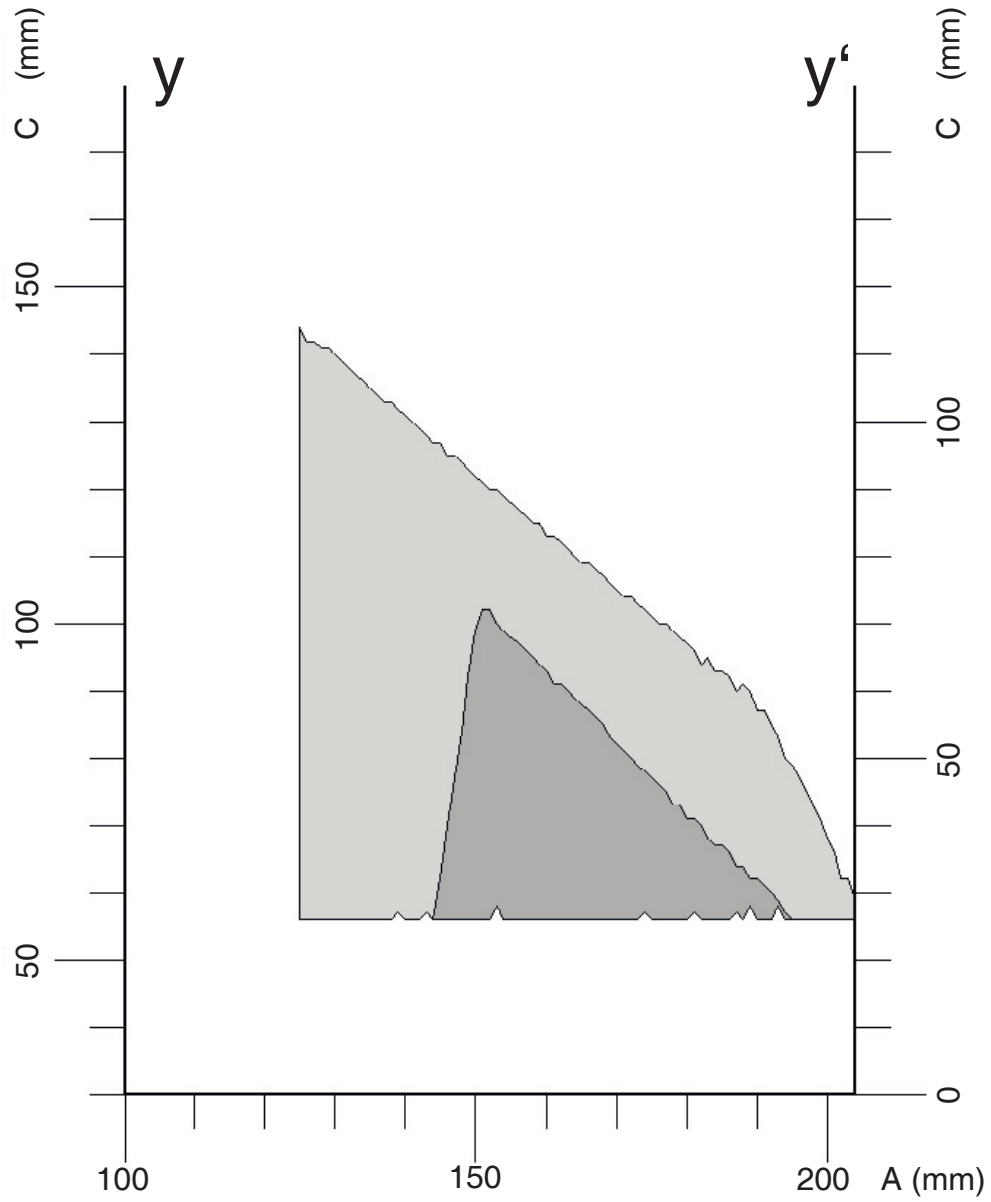

GRAPH 1

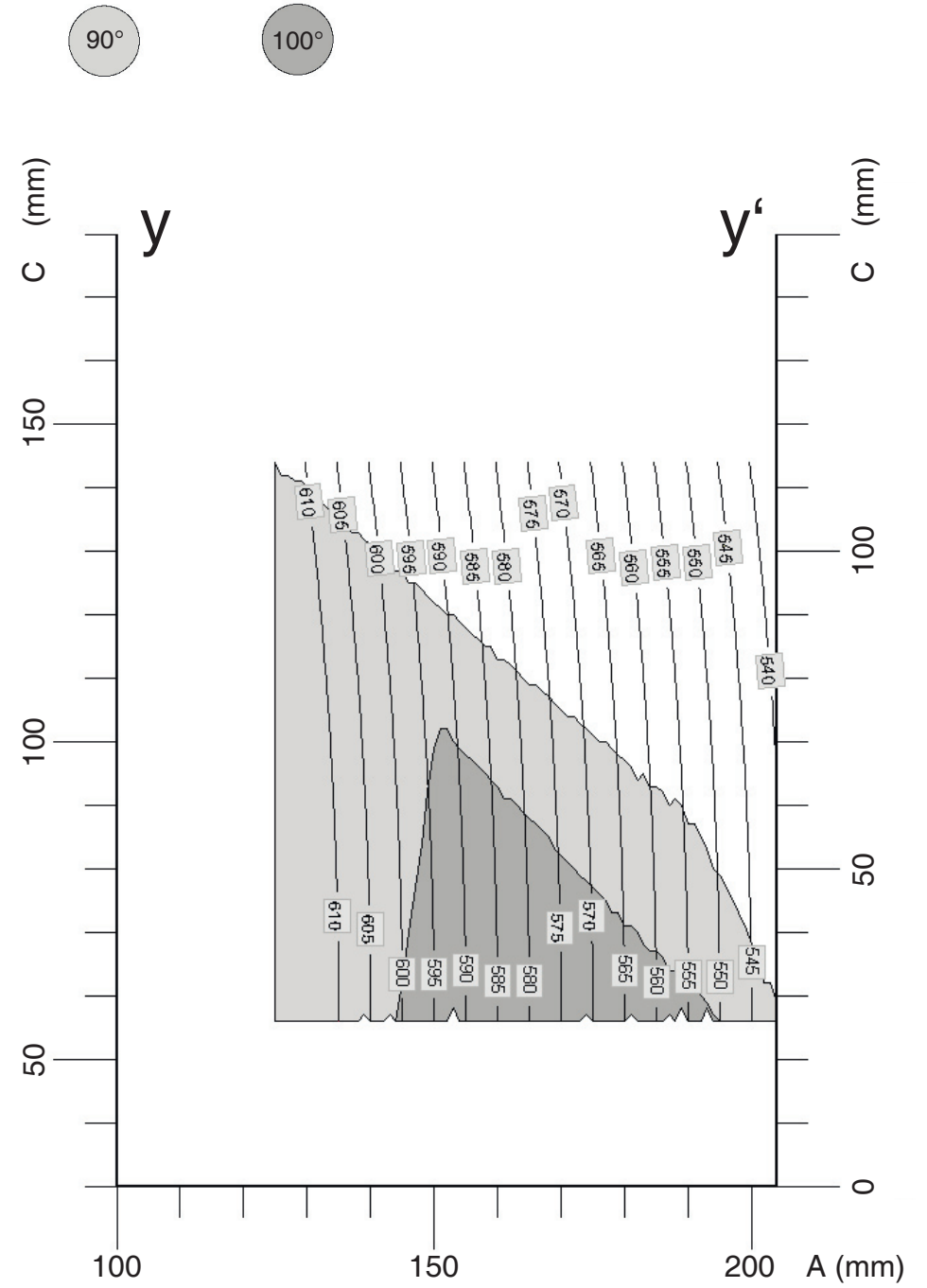

GRAPH 2

INSTALLATION

Read the instructions with care before installing the product. The producer disclaims all responsibility for any damage or bad functioning caused by non-observance of the instructions or bad connection that may result in poor safety and functioning of the gear-motor.

STIRRUPS HEIGHT

Fix the stirrups allowing 45 mm between the faces in order to fix the gear-motor horizontally.

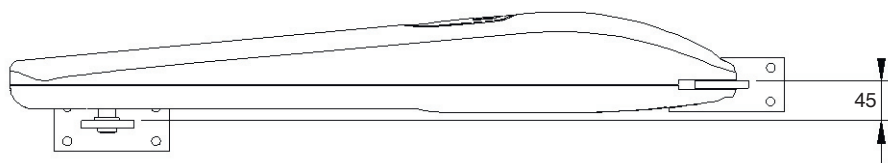

FIXING THE GEAR-MOTOR TO THE STIRRUPS

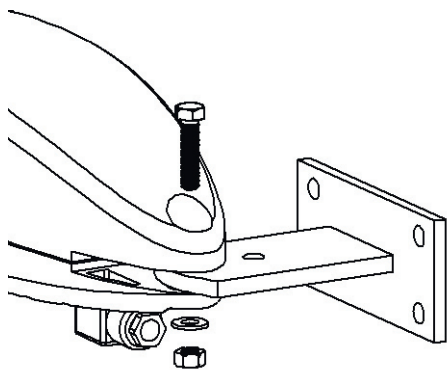

Fixing the gear-motor to the back stirrup.

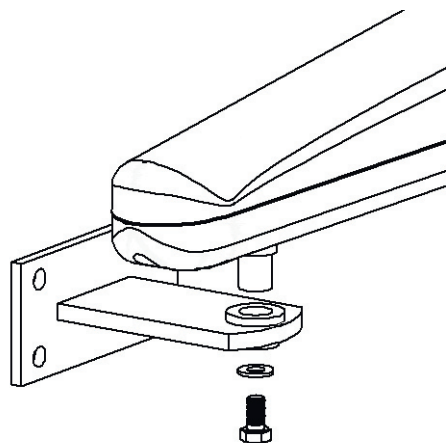

Fixing the gear-motor to the front stirrup.

MANUAL CONTROL

RELEASE

ATTENTION: before operating the manual release disconnect the power. Manual control has been thought for manual opening of the gate in case of power-cut or motor breakdown.

INSTRUCTION (pic. A).

- Operate the manual release moving back the key hole cover.
- Insert the key in the cylinder lock and turn it of 90° clockwise direction.
- Pull the lever till it is perpendicular to the gear-motor.

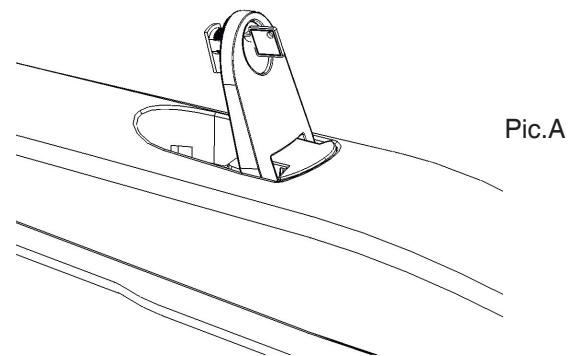

Pic.A

RESTORATION

INSTRUCTION (pic.B)

- Bring back the lever in the original position.
- Insert the key in the cylinder lock and turn it of 90° anticlockwise direction.

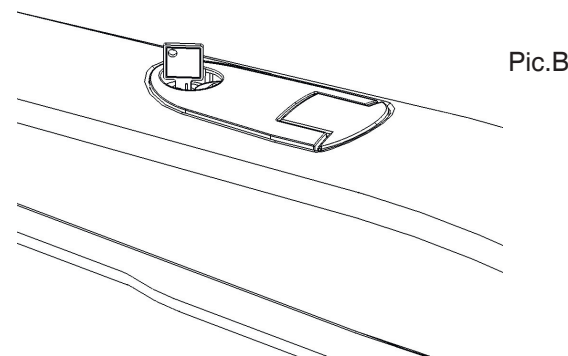

Pic.B

ELECTRICAL CONNECTION

CONNECTION TO THE POWER STATION

The installer is provided with the assembled connector. This has the function of connecting the motor to the power station and to power it. This procedure can only be carried out by authorized staff. Dismantle the connector by unscrewing screw "1" and connect the cables according to the following plan.

ATTENTION : the electrical connection within the gear-motor is already provided.

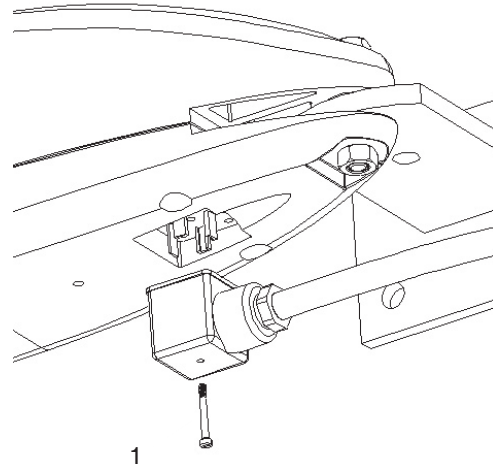

PLAN FOR THE 230 V TYPE

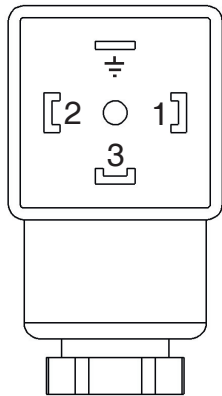

- 1 Open
- 2 Close
- 3 Common
- ≡ Earth

PLAN FOR THE 24 Vdc TYPE

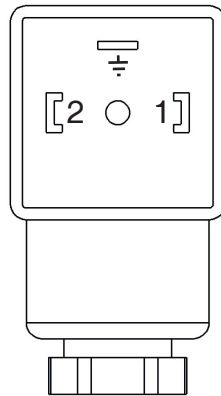

- 1 Open
- 2 Close
- ≡ Earth

ATTENTION: the connector ensures electrical connection insulation. It's therefore very important reassemble with great care.

STOP ADJUSTMENT

The mechanical-stop enables to stop the gate at a required position, avoiding the door hitting the stopping devices.

INSTRUCTION.

- Set the gear-motor on manual functioning (fig.A).
- Unscrew the screw on the mechanical-stop (C).
- Move the door to its wide open desired position.
- Place the mechanical-stop next to the sliding pin (D), as a block.
- Screw in the screw tightly.
- Set the gear-motor on automatic functioning (pic.B).

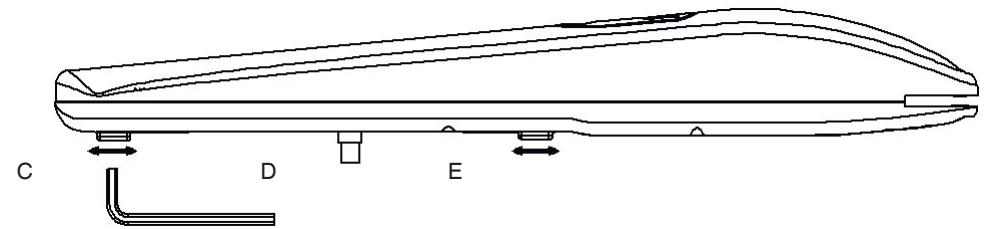

ATTENTION: Jet gear-motor are manually provided with mechanical stops in open position. It's possible to purchase the mechanical stops in close position listed in the King gates catalogue.

SPARE PARTS

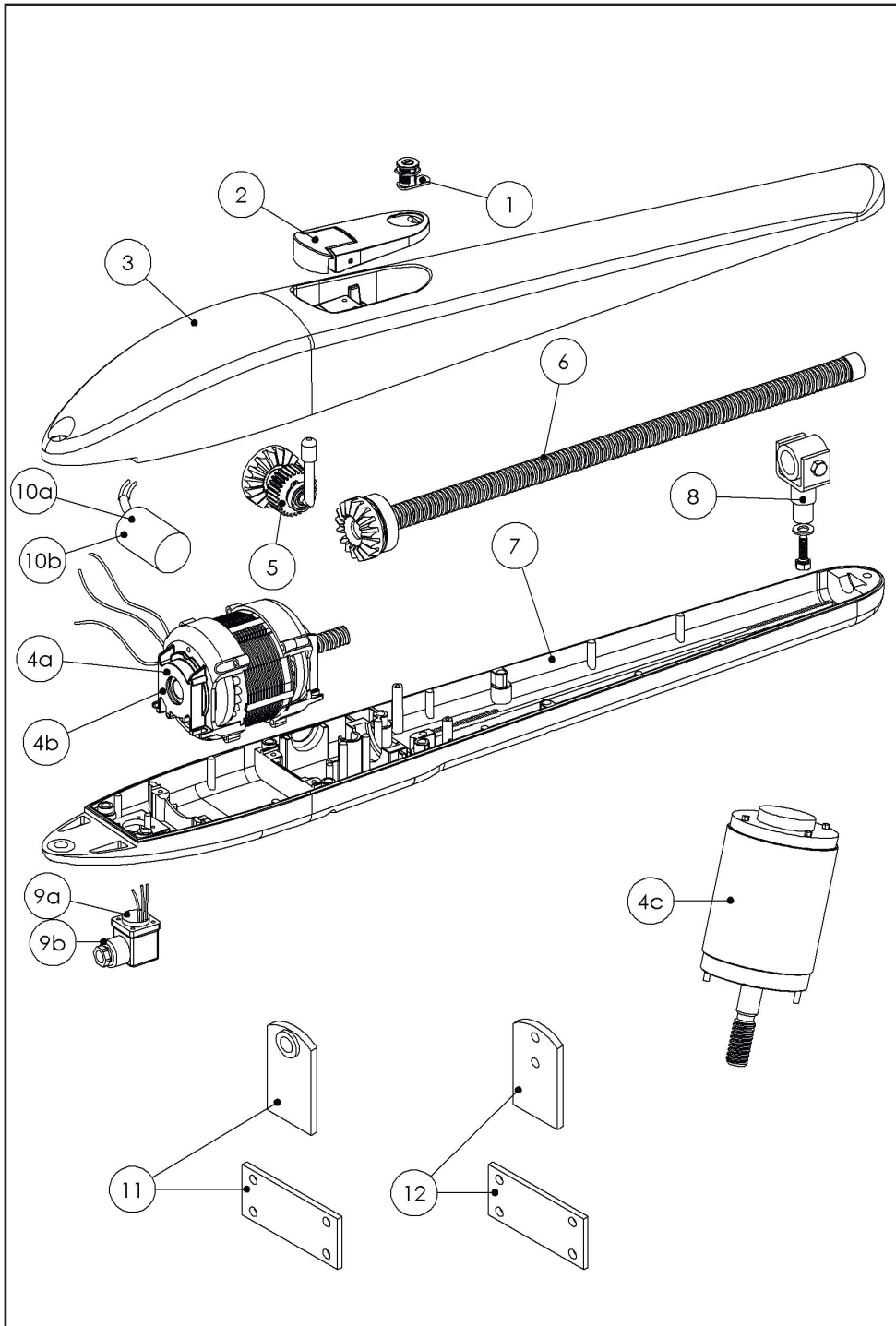

NUMBER

CODE

1-	RSER16
2-	RJ01MS
3-	RJ02AL
4a-	RJ230MF (Jet 230 F)
4b-	RJ230MS (Jet 230 S)
4c-	RJ24MO (Jet 24)
5-	RJ01TM
6-	RJV5P
7-	RJ01AL
8-	RJP5P
9a-	RJC3PT (Jet 230 F / Jet230 S)
9b-	RJC2PT (Jet 24)
10a	RC8CE (Jet 230 F)
10b-	RC10CE (Jet 230 S)
11-	RJ01SA
12-	RJ01SP

DICHIARAZIONE CE DI CONFORMITA'

Il sottoscritto Antoniulli Mario, legale rappresentante della ditta Antoniulli Mario & C. sas, dichiara che il prodotto:

-Jet 230F
-Jet 230S
-Jet 24

Risulta conforme a quanto previsto dalle seguenti direttive europee:

-Direttiva bassa tensione.
Direttiva base 73/23/EEC modificata dalla 93/68/EEC

-Direttiva macchine.
Direttiva base 98/37/EEC modificata dalle 98/79/EC
89/392/EEC
91/368/EEC
93/44/EEC
93/68/EEC

-Compatibilità elettromagnetica.
Direttiva base 89/336/EEC modificata dalle 2004/108/EC
92/31/EEC
93/68/EEC
91/263/EEC

Inoltre dichiara che non è consentita la messa in servizio prima che la macchina in cui il prodotto stesso è incorporato non sia dichiarata conforme alla direttiva macchine 98/37/CE.

Sacile, 01/02/06

Il legale rappresentante,
Antoniulli Mario



EC DECLARATION OF CONFORMITY

The undersigned Mario Antoniulli, general manager of the following producer, declares that the product:

-Jet 230F
-Jet 230S
-Jet 24

Appears to be in conformity with the following community (EEC) regulation:

-Low Voltage Directive.
73/23/EEC 93/68/EEC

-Machinery Directive.
98/37/EEC 98/79EC
89/392/EEC
91/368/EEC
93/44/EEC
93/68/EEC

-Electromagnetic Compatibility.
89/336/EEC 2004/108/EC
92/31/EEC
93/68/EEC
91/263/EEC

The above-mentioned product cannot be used until the machine into which it is incorporated has been identified and declared to comply with the 98/37/CE directive.

Sacile, 01/02/06

General Manager,
Antoniulli Mario

